

# Ehrungen – Rotary Service Above Self Award



# Ehrungen – Rotary Service Above Self Award



# Ehrungen – Rotary Service Above Self Award



# Ehrungen – Rotary Service Above Self Award



## VISION 2005-B3/17 SECONDARY EYE UNIT

### ABBREVIATIONS:

<b>C</b> = CHAIR	<b>B</b> = BENCH
<b>C</b> = CHAIR ON WHEELS	<b>L</b> = LOCKERS
<b>SS</b> = STANDING SHELF	<b>F. B.</b> = FUSE BOX
<b>WS</b> = WALL SHELF	<b>OR</b> = OPERATION ROOM
<b>CU</b> = CUPBOARD	<b>O. M. A.</b> = OPHTHALMIC MEDICAL ASSISTANT
<b>RS</b> = RINSING SINK	<b>OPD</b> = OUT PATIENT DEPARTMENT
<b>SH</b> = SHOWER	<b>LPED</b> = LOCAL PRODUCTION EYE DROPS

### SURFACES:

GREEN AREA:	178 m <sup>2</sup>
YELLOW AREA:	193 m <sup>2</sup>
RED AREA:	124 m <sup>2</sup>
<b>TOTAL:</b>	<b>495 m<sup>2</sup></b>

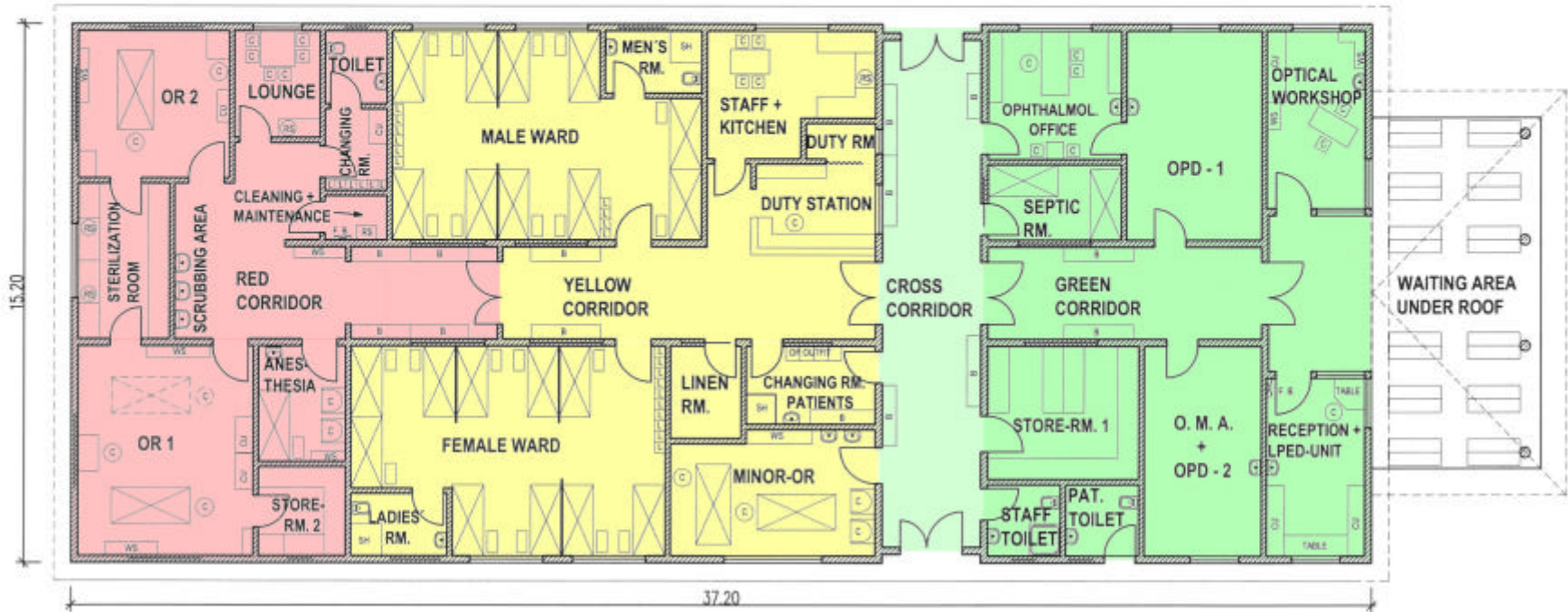

# Ehrungen – Rotary Service Above Self Award



# Ehrungen – Rotary Service Above Self Award



**Seit November 2001  
(Stand 31.05.2006):**

- 543.000 € gesammelt
- 52 Ärzte und Schwestern im Einsatz
- 10 Mann für Logistik und Unterstützung
- 5.200 kg Hilfsgüter per Luftfracht
- plus 3 Container im Juni 2006
- 7.452 Katarakt-Operationen
- 3.138 Operationen u. sonstige Eingriffe
- 25.764 Patienten

# Ehrungen – Rotary Service Above Self Award

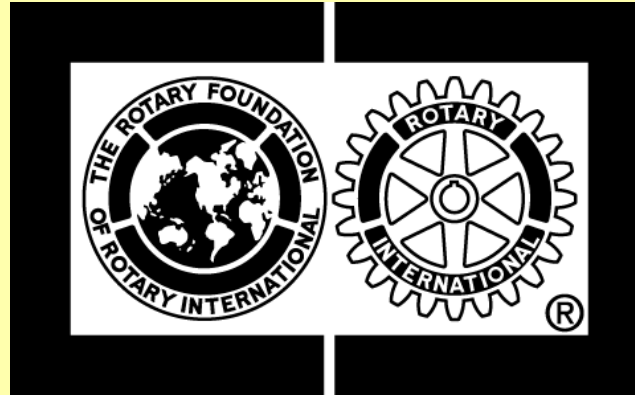

**Bertold von Lindenfels**

**Klaus Hermann Kupke**

**RC Stiftland**

**Projekt:  
Avoidable Blindness**



# Ehrungen – Rotary Service Above Self Award

